

USER MANUAL

080.758 SMART BASE

EN ENGLISH

Manual
in your language?

Check the back cover

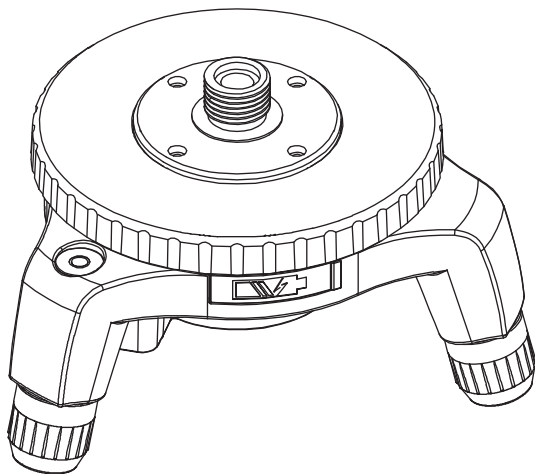

FUTECH
futech-tools.com

OVERVIEW

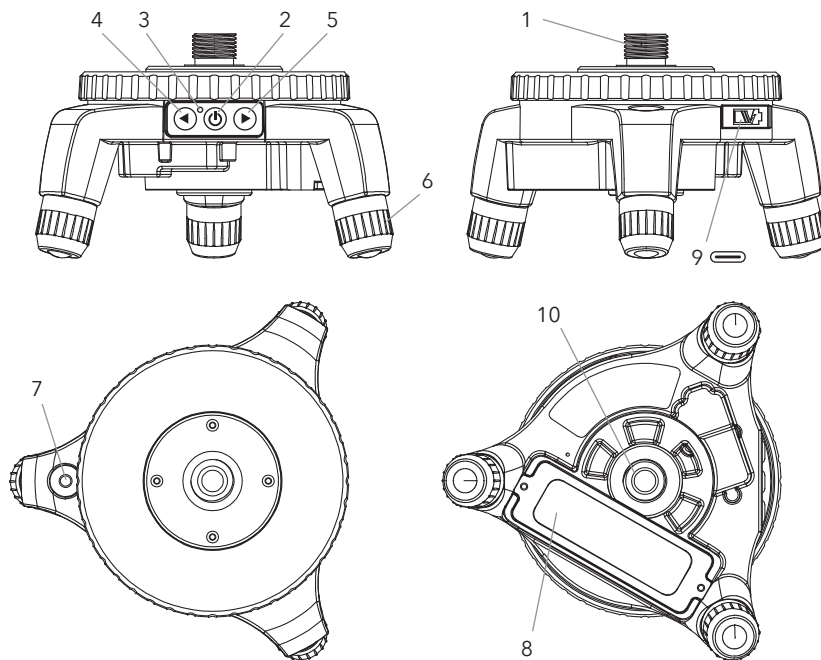

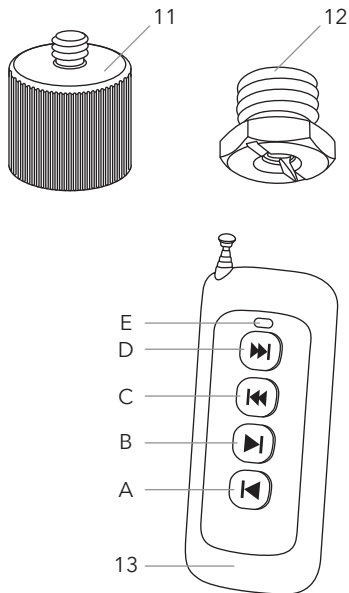

■ SMART BASE

- 1 5/8" screw (M)
- 2 On/Off button
- 3 LED indicator
- 4 Arrow left (↶ - Counterclockwise)
- 5 Arrow right (↷ - Clockwise)
- 6 Adjustable feet
- 7 Bullseye level
- 8 Battery compartment (built-in lithium battery)
- 9 USB-C charging port  for 5V 1A charger (not included)
- 10 5/8" screw (F)
- 11 5/8"F to 1/4"M adapter
- 12 1/4"F to 5/8"M adapter
- 13 Remote control

■ REMOTE CONTROL

- A Arrow left (↶ - Counterclockwise)
- B Arrow right (↷ - Clockwise)
- C Double arrow left (↶ - Counterclockwise)
- D Double arrow right (↷ - Clockwise)
- E LED indicator

BATTERY

■ SMART BASE

The lithium-ion battery, model 18650, 260mAh, is pre-installed in the smart base. To charge it, use a 5V 1A charger (not included) with a USB-C cable.

— BATTERY STATUS INDICATORS

- When the smart base battery is almost empty, the LED indicator [3] will blink red. Charge the battery as soon as possible.
- While the battery is charging, the LED indicator [3] will blink green.
- Once the battery is fully charged, the LED indicator [3] will light up solid green.

■ REMOTE CONTROL

The remote control operates with a 12V 23A alkaline battery. You can replace this battery when the remote control no longer functions correctly or fails to transmit a signal. If you plan to store the remote control for an extended period or it is no longer in use, remove the battery to prevent leakage or damage.

REMOTE CONTROL

The included remote control allows you to operate the smart base from a distance of over 18 meters at two different speeds. However, please note that certain environmental factors may reduce the effective range of the remote control.

The remote control is typically pre-paired with the smart base at the factory. If, for any reason, the pairing was not established, or if you need to replace the remote control with a new one, you can pair it as follows:

- Press and hold the Arrow Left [4] button. The LED indicator [3] will start flashing rapidly.
- While holding Arrow Left [4], press one of the four buttons [A-D] on the remote control.
- The LED indicator [3] will now flash red three times more slowly. This confirms that the pairing between the smart base and the remote control was successful.
- You can now release the Arrow Left [4] button.



USE

■ MANUAL ROTATION

— POWERING ON AND OFF

- Press and hold the On/Off button [2] for approximately 0.5 seconds to turn on the smart base. The LED indicator [3] will remain solid green, indicating that the smart base is now on.
- To turn off the smart base, press and hold the On/Off button [2] for 2 seconds. Once the LED indicator [3] turns off, the smart base is powered down.

— CLOCKWISE ROTATION

Press the Arrow right [5] of the smart base or the Arrow right [B] of the remote control briefly to rotate the smart base one step in the clockwise direction. The LED indicator [3] will flash once briefly.

To rotate a greater distance clockwise, press and hold the Arrow right [5] of the smart base or the Arrow right [B] of the remote control. The smart base will continue rotating as long as the button is held down. In this case, the LED indicator [3] will flash multiple times until the button is released.

For a faster rotation speed, use the Double arrow right [D] of the remote control instead. Holding this button down will rotate the smart base at a higher speed until released.

— COUNTERCLOCKWISE ROTATION

Press the Arrow left [4] of the smart base or the Arrow left [A] of the remote control briefly to rotate the smart base one step in the counterclockwise direction. The LED indicator [3] will flash once briefly.

To rotate a greater distance counterclockwise, press and hold the Arrow left [4] of the smart base or the Arrow left [A] of the remote control. The smart base will continue rotating as long as the button is held down. In this case, the LED indicator [3] will flash multiple times until the button is released.

For a faster rotation speed, use the Double arrow left [C] of the remote control instead. Holding this button down will rotate the smart base at a higher speed until released.

NOTE

When switching between rotation directions, there is a delay of less than 1.5 seconds before the new direction takes effect.



■ CONTINUOUS ROTATION

The smart base can also rotate continuously in the desired direction with a single button press, until the rotation function is deactivated again.

— POWERING ON AND OFF

Turn on continuous rotation mode by pressing and holding both the Arrow left [4] of the smart base and the On/Off button [2] simultaneously for approximately 0.5 seconds, until the LED indicator [3] lights up solid red. This indicates that the smart base is now in continuous rotation mode.

— CLOCKWISE ROTATION

To rotate clockwise, briefly press the Arrow right [5] of the smart base.

To stop the rotation, press the Arrow right [5] of the smart base again.

— COUNTERCLOCKWISE ROTATION

To rotate counterclockwise, briefly press the Arrow left [4] of the smart base.

To stop the rotation, press the Arrow left [4] of the smart base again.

NOTE

You can also switch rotation directions immediately by pressing the button for the opposite direction.

When switching between rotation directions, there is a delay of less than 1.5 seconds before the new direction takes effect.

— REMOTE CONTROL FUNCTIONS

Using the remote control while the smart base is in continuous rotation mode will interrupt the continuous movement and override it with the corresponding remote control function. However, the continuous rotation mode itself is not deactivated.

The functions of the remote control remain the same as in manual rotation mode, allowing you to control the smart base as usual.

To resume continuous rotation, you must use the Arrow left [4] of the smart base or Arrow right [5] of the smart base as described above.





DECLARATION OF CONFORMITY

Futech (Belgium) declares under its own responsibility that this device:

- 080.758 SMART BASE

is in conformity with the standards

RED DIRECTIVE 2014/53/EU:

Article 3.1a

- EN IEC 62368-1:2020 + A11:2020
- EN 62479:2010
- EN 50663:2017

Article 3.2b

- ETSI EN 301 489-1 V2.2.3 (2019-11)
- ETSI EN 301 489-3 V2.3.2 (2023-01)
- EN 55032:2015 + A1:2020 + A11:2020
- EN 55035:2017 + A11:2020

Article 3.2

- ETSI EN 300 220-1 V3.1.1 (2017-02)
- ETSI EN 300 220-2 V3.2.1 (2018-06)

Lier, Belgium,
March, 2025
Patrick Wauters

Includes

- Smart base
- Remote control with batteries
- 5/8"m to 1/4"f adapter
- 1/4"m to 5/8"f adapter
- USB-c charging cable
- Instuction manual



USER MANUAL

other languages:



DA DANSK



DE DEUTSCH



ES ESPAÑOL



ET EESTI KEEL



FI SUOMEN KIELI



FR FRANÇAIS



IS ÍSLENSKA



IT ITALIANO



NL NEDERLANDS



NO NORSK



PT PORTUGUÊS



SL SLOVENŠČINA



SV SVENSKA



Facebook
@futechtools



LinkedIn
futechtools



World Wide Web
futech-tools.com



YouTube
@futechtools